



Special Event Permit

2025-17

All fees have been paid in full as required by this permit. This special event permit shall expire and be null and void at the conclusion of the event, if any conditions herein are breached, or if the permit is transferred to any other person, corporation, organization, or entity.

Event Information

Event Name: **2025 LoToJa Classic**
Event Type: Bicycle Race and Ride
Event Date(s): September 5-6, 2025

Promoting Entity: Epic Events LLC
Applicant: Brent Chambers
Phone: (801)389-5008
Email: brent@lotoja.com

 28 July 25
Approved by: Land Use Authority Date

Conditions of Approval

1. All participants and volunteers shall comply with County Ordinance §8.40 governing special events.
2. Event organizers must comply with the information as submitted in the Special Event application.
3. Public safety will be handled by the applicant as outlined in the application.
4. Riders and support vehicles must yield to emergency vehicles when they are responding to an emergency.
5. This event is inside of the wildfire season and are subject to road closures and evacuation in the event of a wildfire.
6. Applicant must coordinate with individual jurisdictions where the event crosses from unincorporated County into an incorporated municipality or other jurisdiction.

Agreement of Acceptance

As the applicant for the special event described above, I hereby agree to comply with all Federal, State, and County laws, ordinances, and regulations before, during and after the event. I further agree to indemnify and save harmless Cache County, its officers, agents, and employees from and against any and all claims resulting from the use of the premises by the Applicant, the Applicant's invitees, licensees, agents and employees. I agree to permit law enforcement personnel the free and unrestricted access to and upon the premises at all times during the event for all lawful and proper purposes not inconsistent with the intent of the permit.

Continued on Pg. 2



SEP 2025-117 LoToJa Classic Pg. 2

I understand and agree that this permit may be revoked upon breach of any of the conditions herein or at the discretion of the authorized officer. I understand that this permit is not transferable and agree not to transfer my permit to any person, corporation, organization or other entity.

In Accordance with Title 8 Section 8.40 of the Cache County Ordinance, I hereby submit and certify that the above information provided is accurate and complete to the best of my knowledge.

Brent Chambers

7/28/2025

Accepted by: Applicant

Date



CACHE COUNTY FIRE DISTRICT

600 North 1020 East
Hyrum, Utah 84319
(435) 755-1670

To: Mimi Calverley
From: Troy Fredrickson
2025 LoToJa Classic

07/15/25

This event is inside of the wildfire season. The roads that are being used and the area that the roads are in could be subjected to closures and evacuation in the event of a wildfire.

In the past there has been a problem in other events where cyclist were not yielding to emergency vehicles when they were responding to an emergency.

I would advise that the cyclist and support vehicles be reminded to yield to emergency vehicles and obey all traffic laws.

SEP Proposal: LoToJa Classic 2025

Alex Hutchinson <ahutchinson@brhdut.gov>

Wed, Jul 16, 2025 at 9:43 AM

To: Mimi Calverley <mimi.calverley@cachecounty.gov>

Cc: Troy Fredrickson <troy.fredrickson@cachecounty.gov>, Reed Tanner <rtanner@cashesheriff.gov>

Looks great to me, thanks Mimi!

On Tue, Jul 15, 2025 at 11:45 AM Mimi Calverley <mimi.calverley@cachecounty.gov> wrote:

[Quoted text hidden]

Public Works- SEP Proposal LoToJa Classic 2025

Jeremy Hudson <jeremy.hudson@cachecounty.gov>
To: Mimi Calverley <mimi.calverley@cachecounty.gov>

Wed, Jul 16, 2025 at 5:41 AM

We do not have anything planned as far as maintenance on the above mentioned route.

Thank you

Jeremy Hudson
Road Superintendent
[1020 E 600 N](#)
[Hyrum UT 84319](#)
Phone 435-755-1566
Cell 435-757-4729
Email jeremy.hudson@cachecounty.gov

PLEASE NOTE: Cache County is moving to a .gov domain and all emails intended for me should be sent to the address in my signature above

On Tue, Jul 15, 2025 at 11:56 AM Mimi Calverley <mimi.calverley@cachecounty.gov> wrote:
[Quoted text hidden]

Public Works- SEP Proposal LoToJa Classic 2025

Matt Phillips <matt.phillips@cachecounty.gov>

Tue, Jul 15, 2025 at 7:14 PM

To: Mimi Calverley <mimi.calverley@cachecounty.gov>

Mimi,

No issues from my side, looks like they are working with local law enforcement on Traffic Control.

Matt

[Quoted text hidden]



Cache County

1857

Development Services Department

Building | Surveying | Engineering | GIS | Planning & Zoning | Roads | Weeds

Application: Special Event Permit

Date Received:	By:	Receipt #:	Check#:	
July 17, 2025	Mimi Calverley	21501	credit card	\$75.00

Event Information

Event: 2025 LoToJa Classic Type: Bicycle race and ride
- Friday, Sept 5: 9:00 AM - 9:00 PM - Setup, Expo, Packet Pickup, Cleanup
Dates with staning/ending limes: - Saturday, Sept 6: 5:00 - 9:00 AM - Race/Ride in Cache County

Agent/Contact Information

Agent/Contact: Brent Chambers Email: brent@lotoja.com
Phone: 801.389.5008 Mailing Address: Epic Events, P.O. Box 1912, Layton, UT 84041
Name of Promoting Entity: Epic Events LLC

Acknowledgment

In accordance with Title 8 Section 8.40 of the Cache County Ordinance, I hereby submit and certify that the information contained in this application is accurate and complete to the best of my knowledge.^

[Signature]
aw

7/11/2025

Date

Application Deadline: Completed application forms must be submitted to the Cache County Development Services Office forty-five (45) calendar days before an event is scheduled to take place. This allows sufficient time for evaluation of the application. Late applications shall be denied unless the applicant demonstrates that compliance with the 45 day deadline was impractical or impossible due to the nature of the event. A special event permit application may be approved and a permit issued to the applicant by the Director upon approval by all the agencies specified in Section 8.40.40.

Authority: Cache County has no authority to approve permits for events other than in the unincorporated area of Cache County. Permits issued by Cache County apply only to the unincorporated area of the county, and if an event crosses into a municipality within Cache County or across the county line, applicants should determine if a permit is necessary in the other jurisdiction.

Right to Deny: Cache County reserves the right to deny permit applications for proposed special events which may pose, or have posed a significant danger or threat to the public health, welfare or safety, or which may result in unreasonable inconvenience or cost to the public. In the event the application is denied, the applicant may appeal to the Cache County Executive.

APPLICATION CHECKLIST

A complete application must include the following unless specified otherwise:

- 1) ☒ Completed application form and application fee (\$75 – no refunds) submitted 45 days prior to event. Additional fees for services provided by the Sheriff's Office, emergency services, or others may apply.
- 2) ☒ Proposed location, including a plat or map of the proposed area to be used, including any barricade, street route plans or perimeter/security fencing.
- 3) ☒ Total number of participants: Estimate must include event staff, participants, and spectators.
- 4) ☒ Public health plans, including plans for culinary water supplies, solid waste collections and disposal, and waste water (toilet facilities).
- 5) ☒ Proof of insurance in conformance with the County Ordinance 8.40.050(F) minimums: \$1,000,000 each occurrence, \$2,000,000 general aggregate, and \$100,000 property damage.
- 6) ☒ Fire prevention and emergency medical services plans.
- 7) ☒ Security plans and/or law enforcement response.
- 8) ☒ Admission fee, donation, or other consideration to be charged or requested.
- 9) ☒ Plans for parking
- 10) ☒ *If* the event will be held on private property, a current taxation certification for that property.
- 11) ☒ Further information may be required by staff, other departments and agencies, and/or the Board/Committee/Council that reviews the application based on the proposed event.

PROJECT REVIEW PROCESS

- The applicant is encouraged to meet with staff prior to the deadline date to discuss the project and ensure that the information submitted is sufficient to provide a complete review of the project.
 - After the application is accepted, information packets are sent to various departments, agencies, and affected municipalities that provide comments and/or approval for the proposed event to the Director of Development Services.
 - In some instances a pre-event meeting may be held with planning staff and representatives from the departments and agencies that provide comments on the project review. Any issues present on a project will be discussed with the appropriate department or agency.
 - A draft permit is made available to the reviewing agencies, affected municipalities, staff, and the applicant.
 - Following agency/department review and approval, and correction of any outstanding concerns/issues, the permit can be issued.
-



ADDITIONAL APPLICATION DETAILS:

- Estimated Numbers:

Event Staff: Friday (in Logan) 60; Saturday (on course) 600 plus

Spectators: 1,500

Participants: 1,400

- Public Health Plans:

Complimentary bottled water will be available at the packet pickup area on Friday for those attending the Expo and/or registered applicants "checking in". Portable toilets and wash basins will also be provided in the same area (see Street Festival PDF for setup diagram). Our vendor for this service will be Honey Bucket. We have also placed a trash receptacle and recycle bin from Logan City for disposal of trash. On Saturday, portable toilets are provided on course and placed every 5 to 10 miles from Logan all the way to Jackson.

- Fire Prevention, Emergency Services, and Law Enforcement Plan/Response:

Friday Expo - Logan City Fire Department is one-half block away from our event expo and start line. They will be contacted and alerted in the unlikely event additional services are needed. Logan City Police will also be involved during the event.

Saturday Ride - We have several neutral support volunteers with EMS certification. This includes over 150 HAM radio operators (stationary and mobile) on course providing communications and neutral support with every start pack. Local, county, and state law enforcement have been alerted. Logan City Police Department will provide traffic control and a police escort out of town. Utah Highway Patrol will provide traffic control at key intersections along the race and ride routes to the Utah-Idaho border. County Sheriff's Office as well as North Park and Smithfield Police Departments will be patrolling and providing traffic control. Several Corner and Course Marshals will be placed throughout Cache Valley to provide direction, assist neutral support vehicles, and assist in the event of an accident.

Calling "911" is also an option. Logan Regional, along with every other hospital along LoToJa's race route, will be on alert.

- Admission Fee:

The LoToJa Expo on Friday is open to everyone. There is no admission fee. Cyclists participating in LoToJa on Saturday, pay their entry fee May-June (with successful selection of their online application).

- Parking Plans:

This is only applicable in Logan on Friday afternoon and Saturday morning. For locations, see Course Maps in the Cyclist Bible.



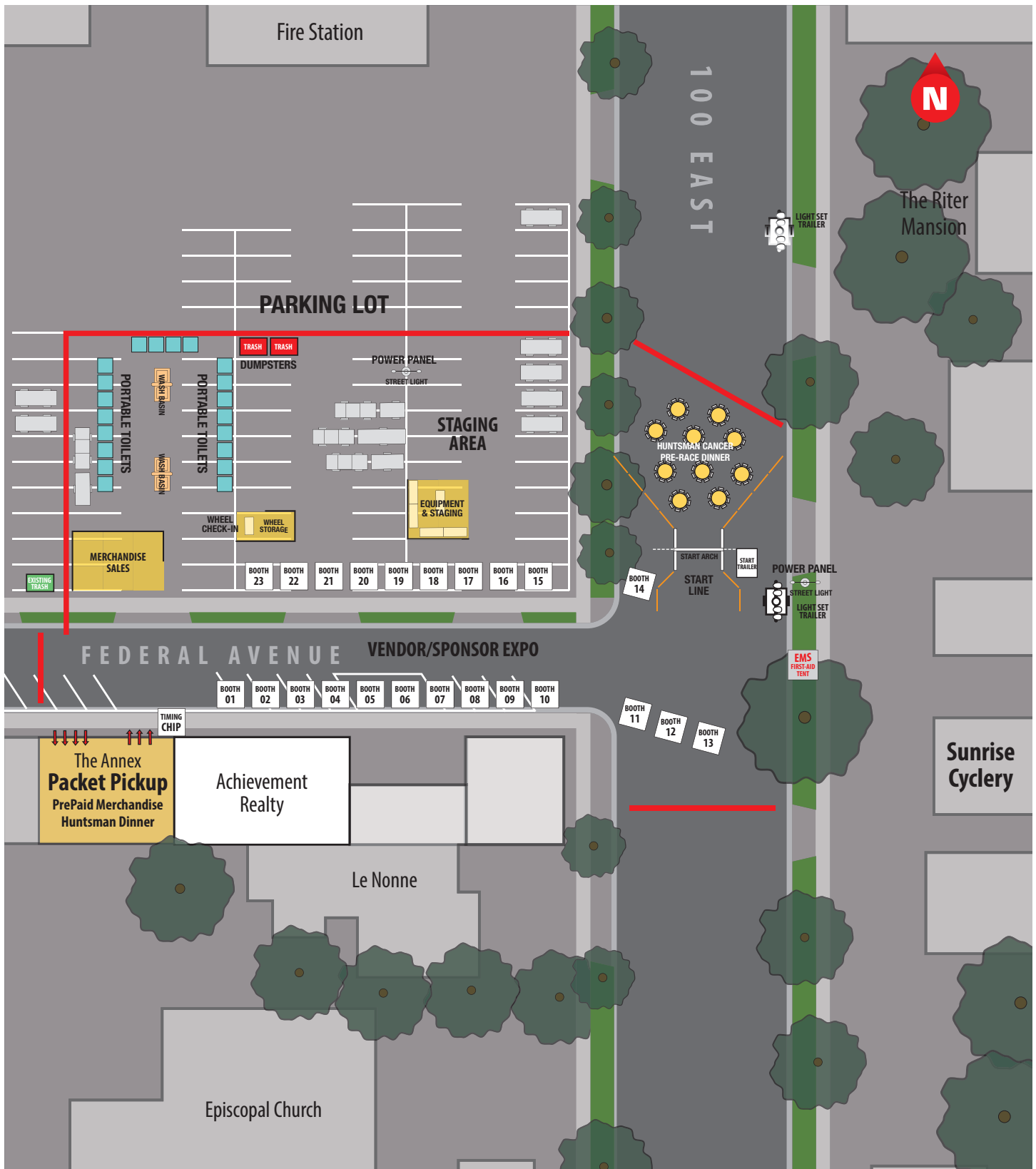



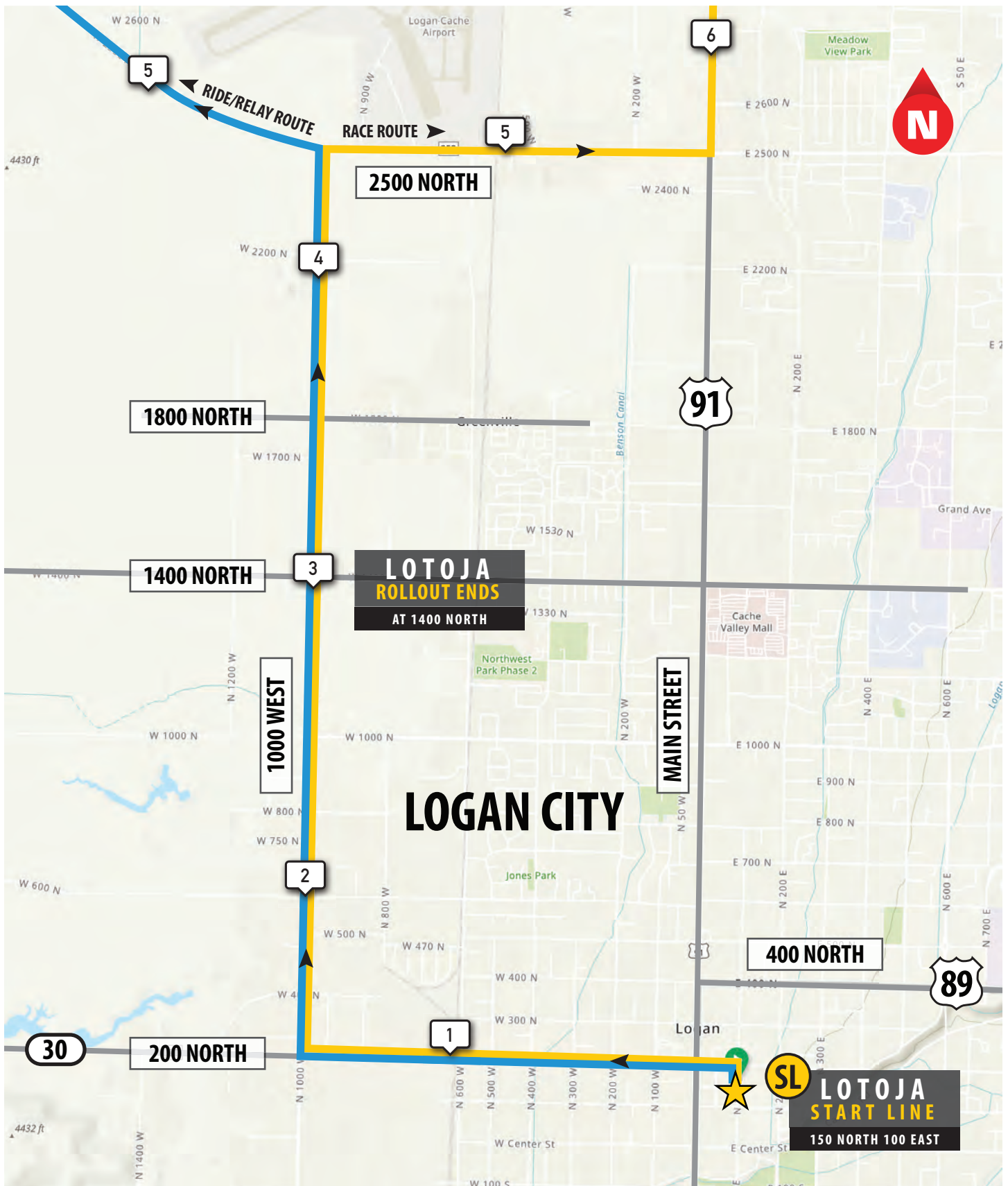

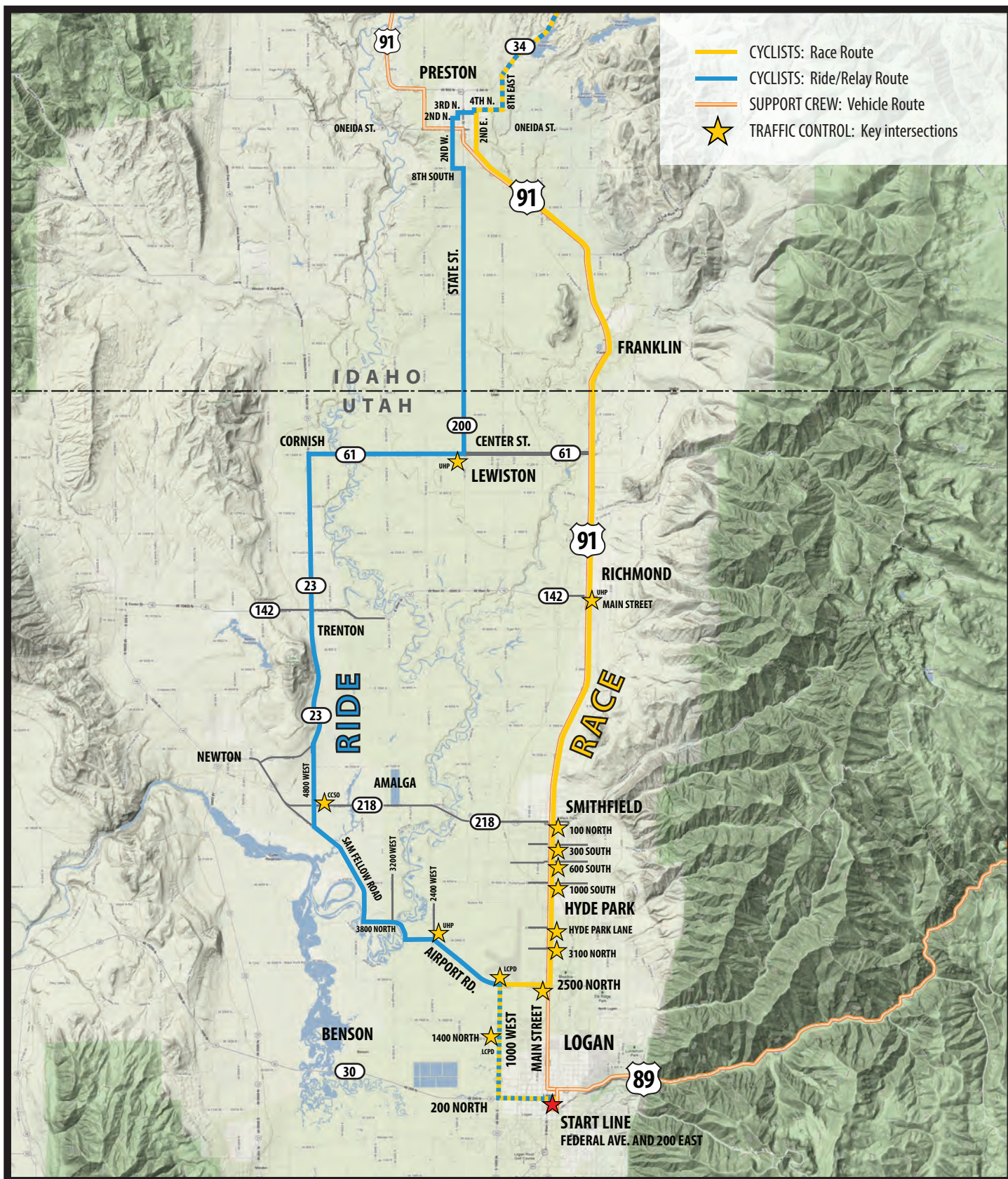

ACORDTM**CERTIFICATE OF LIABILITY INSURANCE**

DATE (MM/DD/YYYY)

4/28/2025

THIS CERTIFICATE IS ISSUED AS A MATTER OF INFORMATION ONLY AND CONFERS NO RIGHTS UPON THE CERTIFICATE HOLDER. THIS CERTIFICATE DOES NOT AFFIRMATIVELY OR NEGATIVELY AMEND, EXTEND OR ALTER THE COVERAGE AFFORDED BY THE POLICIES BELOW. THIS CERTIFICATE OF INSURANCE DOES NOT CONSTITUTE A CONTRACT BETWEEN THE ISSUING INSURER(S), AUTHORIZED REPRESENTATIVE OR PRODUCER, AND THE CERTIFICATE HOLDER.

IMPORTANT: If the certificate holder is an **ADDITIONAL INSURED**, the policy(ies) must have **ADDITIONAL INSURED** provisions or be endorsed. If **SUBROGATION** IS WAIVED, subject to the terms and conditions of the policy, certain policies may require an endorsement. A statement on this certificate does not confer any rights to the certificate holder in lieu of such endorsement(s).

PRODUCER Fairly Consulting Group LLC 1800 S Washington St, Ste 400 Amarillo, TX 79102	CONTACT NAME: Fairly Group Certificates PHONE (A/C, No, Ext): FAX (A/C, No): E-MAIL ADDRESS: certs@fairlygroup.com																					
INSURED USA Cycling, Inc. 210 USA Cycling Pt, Suite 100 Colorado Springs, CO 80919-2214	<table border="1"> <tr> <th colspan="2">INSURER(S) AFFORDING COVERAGE</th><th>NAIC #</th></tr> <tr> <td colspan="2">INSURER A : Clear Blue Insurance Company</td><td>28860</td></tr> <tr> <td colspan="2">INSURER B :</td><td></td></tr> <tr> <td colspan="2">INSURER C :</td><td></td></tr> <tr> <td colspan="2">INSURER D :</td><td></td></tr> <tr> <td colspan="2">INSURER E :</td><td></td></tr> <tr> <td colspan="2">INSURER F :</td><td></td></tr> </table>	INSURER(S) AFFORDING COVERAGE		NAIC #	INSURER A : Clear Blue Insurance Company		28860	INSURER B :			INSURER C :			INSURER D :			INSURER E :			INSURER F :		
INSURER(S) AFFORDING COVERAGE		NAIC #																				
INSURER A : Clear Blue Insurance Company		28860																				
INSURER B :																						
INSURER C :																						
INSURER D :																						
INSURER E :																						
INSURER F :																						

COVERAGES**CERTIFICATE NUMBER:****REVISION NUMBER:**

THIS IS TO CERTIFY THAT THE POLICIES OF INSURANCE LISTED BELOW HAVE BEEN ISSUED TO THE INSURED NAMED ABOVE FOR THE POLICY PERIOD INDICATED. NOTWITHSTANDING ANY REQUIREMENT, TERM OR CONDITION OF ANY CONTRACT OR OTHER DOCUMENT WITH RESPECT TO WHICH THIS CERTIFICATE MAY BE ISSUED OR MAY PERTAIN, THE INSURANCE AFFORDED BY THE POLICIES DESCRIBED HEREIN IS SUBJECT TO ALL THE TERMS, EXCLUSIONS AND CONDITIONS OF SUCH POLICIES. LIMITS SHOWN MAY HAVE BEEN REDUCED BY PAID CLAIMS.

INSR LTR	TYPE OF INSURANCE	ADDL INSR	SUBR WVD	POLICY NUMBER	POLICY EFF (MM/DD/YYYY)	POLICY EXP (MM/DD/YYYY)	LIMITS
A	<input checked="" type="checkbox"/> COMMERCIAL GENERAL LIABILITY <input type="checkbox"/> CLAIMS-MADE <input checked="" type="checkbox"/> OCCUR <input checked="" type="checkbox"/> GA applies per event GEN'L AGGREGATE LIMIT APPLIES PER: <input type="checkbox"/> POLICY <input type="checkbox"/> PRO-JECT <input type="checkbox"/> LOC <input checked="" type="checkbox"/> OTHER:	X		CZ26COGL0002-01	12/31/2024	12/31/2025	EACH OCCURRENCE \$2,000,000 DAMAGE TO RENTED PREMISES (Ea occurrence) \$2,000,000 MED EXP (Any one person) \$Excluded PERSONAL & ADV INJURY \$2,000,000 GENERAL AGGREGATE \$4,000,000 PRODUCTS - COMP/OP AGG \$2,000,000 Part Legal \$2,000,000
	AUTOMOBILE LIABILITY <input type="checkbox"/> ANY AUTO <input type="checkbox"/> OWNED AUTOS ONLY <input type="checkbox"/> SCHEDULED AUTOS <input type="checkbox"/> HIRED AUTOS ONLY <input type="checkbox"/> NON-OWNED AUTOS ONLY						COMBINED SINGLE LIMIT (Ea accident) \$ BODILY INJURY (Per person) \$ BODILY INJURY (Per accident) \$ PROPERTY DAMAGE (Per accident) \$ \$
	UMBRELLA LIAB <input type="checkbox"/> OCCUR EXCESS LIAB <input type="checkbox"/> CLAIMS-MADE DED \$ RETENTION \$						EACH OCCURRENCE \$ AGGREGATE \$ \$
	WORKERS COMPENSATION AND EMPLOYERS' LIABILITY ANY PROPRIETOR/PARTNER/EXECUTIVE OFFICER/MEMBER EXCLUDED? <input type="checkbox"/> Y / N (Mandatory in NH) If yes, describe under DESCRIPTION OF OPERATIONS below		N / A				PER STATUTE <input type="checkbox"/> OTH-ER <input type="checkbox"/> E.L. EACH ACCIDENT \$ E.L. DISEASE - EA EMPLOYEE \$ E.L. DISEASE - POLICY LIMIT \$

DESCRIPTION OF OPERATIONS / LOCATIONS / VEHICLES (ACORD 101, Additional Remarks Schedule, may be attached if more space is required)

Named Insured Extension:

Event Organizers and/or Promoters are Named Insureds. It shall be a condition of coverage that all organizers/promoters for whom coverage is afforded under this policy execute a USAC Event Permit Application and coverage will be afforded only for the specific event and date(s) on the permit.

The General Liability policy includes a blanket automatic additional insured endorsement that provides (See Attached Descriptions)

CERTIFICATE HOLDER**CANCELLATION**

Cache County Corp 199 N Main Street Logan, UT 84321	SHOULD ANY OF THE ABOVE DESCRIBED POLICIES BE CANCELLED BEFORE THE EXPIRATION DATE THEREOF, NOTICE WILL BE DELIVERED IN ACCORDANCE WITH THE POLICY PROVISIONS. AUTHORIZED REPRESENTATIVE 
--------------------------------------------------------------------------------	--------------------------------------------------------------------------------------------------------------------------------------------------------------------------------------------------------------------------------------------------------------------------------------------

DESCRIPTIONS (Continued from Page 1)

additional insured status to any person or organization if required by a written contract or agreement provided such contract or agreement was executed prior to the occurrence or offense. Please see attached endorsement CG 20 26 (12/2019).

Event Number: 2025-10937

Event Name: LoToJa Classic RR

Event Location: Logan, UT

Event Date(s): 09/06/2025

THIS ENDORSEMENT CHANGES THE POLICY. PLEASE READ IT CAREFULLY.

ADDITIONAL INSURED – DESIGNATED PERSON OR ORGANIZATION

This endorsement modifies insurance provided under the following:

COMMERCIAL GENERAL LIABILITY COVERAGE PART

SCHEDULE

Name Of Additional Insured Person(s) Or Organization(s)
Blanket as required by Written Contract issued prior to loss.
Information required to complete this Schedule, if not shown above, will be shown in the Declarations.

Section II – Who Is An Insured is amended to include as an additional insured the person(s) or organization(s) shown in the Schedule, but only with respect to liability for "bodily injury", "property damage" or "personal and advertising injury" caused, in whole or in part, by your acts or omissions or the acts or omissions of those acting on your behalf:

- A.** In the performance of your ongoing operations; or
- B.** In connection with your premises owned by or rented to you.