



SPECIAL EVENT PERMIT

2019-20

All fees have been paid in full as required by this permit. This special event permit shall expire and be null and void at the conclusion of the event, if any conditions herein are breached, or if the permit is transferred to any other person, corporation, organization, or entity.

EVENT INFORMATION

Event Name: **Granger Smith Concert**

Event Date(s): **2 August 2019**

Applicant: John Chadwick

Event Type: Concert

Phone: (435)890-7827

Promoting Entity: Cherry Peak Resort

Email: john@skicherrypeak.us

Sponsoring Entity: Cherry Peak Resort

01 AUG 2019

Approved by: Land Use Authority

Date

CONDITIONS OF APPROVAL

1. All participants and volunteers must comply with County Ordinance §8.40 governing special events.
2. **Event organizers must comply with the information as submitted in the Special Event application and the approved current conditional use permit.**
3. Bear River Health Department requires all food vendors must be licensed and permitted.
4. As necessary, event organizers, staff, participants, and spectators must allow access for emergency vehicles in case of a wildland fire. Fire extinguishers must be readily available in the event of a fire.
5. Due to the inherently higher life safety risks associated with special events involving gatherings of more than 1000 people the Cache County Fire District will also require:
 - a. **Fire Watch:** It is essential for public safety in a place of assembly or any other place where people congregate, because of the number of persons, or the nature of the performance, exhibition, display, contest or activity, the owner, agent or lessee shall provide one or more fire watch personal, as required and approved, to remain on duty during the times such places are open to the public, or when such activity is being conducted. [IFC 403.1]
 - b. **Public Safety Plan:** A public safety plan will need to be submitted to the Cache County Fire District a week prior to the event. Where the fire code official determines that an indoor or outdoor gathering of persons has an adverse impact on public safety through diminished access to buildings, structures, fire hydrants and fire apparatus access roads or where such gatherings adversely affect public safety services of any kind, the fire code official shall have the authority to order the development of, or prescribe a plan for, the provision of any approved level of public safety. [IFC 403.2]
 - c. **Crowd Managers:** Trained crowd managers shall be provided for facilities or events where more than 1,000 persons congregate. The minimum number of crowd managers shall be established at a ratio of one crowd manager to every 250 persons. Where approved by the fire code official, the ratio of crowd managers shall be permitted to be reduced where the facility is equipped throughout with an approved automatic sprinkler system or based upon the nature of the event.

- d. **Apparatus Standby:** As part of the public safety plan, the event organizer is required to have necessary fire apparatus on-site as determined by the Authority Having Jurisdiction (AHJ). Apparatus standby costs shall be reimbursed to the county at standard deployment rate as determined by Utah Forestry, Fire and State Lands rate agreement.
 - e. **Parking:** A parking manager will need to be assigned to oversee effective parking procedures. Parking will only be allowed on green grass and dirt lots without any vegetation. Parking will only be allowed in the appropriate locations shown on the current conditional use permit. The parking manager must follow all Cache County parking restrictions.
 - f. **Fireworks:** Fireworks are not allowed per Authority Having Jurisdiction.
6. Failure to meet any of the conditions of this permit, including parking outside of areas identified in the existing recorded conditional use permit, is a violation of this permit and the recorded conditional use permit (CUP). Violations of the conditions of the CUP will be presented to the County Planning Commission to determine if the existing CUP should be revoked.
 7. Applicant has provided a contingency plan for parking in the case of inclement weather. An email from Richmond City and contracted Fire Chief allowing some parking within the city is in the file.

AGREEMENT OF ACCEPTANCE

As the applicant for the special event described above, I hereby agree to comply with all Federal, State, and County laws, ordinances, and regulations before, during and after the event. I further agree to indemnify and save harmless Cache County, its officers, agents, and employees from and against any and all claims resulting from the use of the premises by the Applicant, the Applicant's invitees, licensees, agents and employees. I agree to permit law enforcement personnel the free and unrestricted access to and upon the premises at all times during the event for all lawful and proper purposes not inconsistent with the intent of the permit. I understand and agree that this permit may be revoked upon breach of any of the conditions herein or at the discretion of the authorized officer. I understand that this permit is not transferable and agree not to transfer my permit to any person, corporation, organization or other entity and is only valid within the unincorporated county. In Accordance with Title 8 Section 8.40 of the Cache County Ordinance, I hereby submit and certify that the above information provided is accurate and complete to the best of my knowledge.

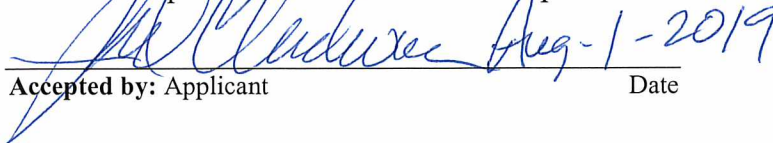
 Aug-1-2019

Accepted by: Applicant

Date



CACHE COUNTY SHERIFF'S OFFICE

D. CHAD JENSEN, SHERIFF

Matt Bilodeau, Chief Deputy

Brian Locke, Lieutenant

Doyle Peck, Lieutenant

Mikelshan Bartschi, Lieutenant

EMPATHY

FAIRNESS

INTEGRITY

PROFESSIONALISM

RESPECT

RESPONSIBILITY

TRUSTWORTHINESS

To: Cache County

From: Sgt. Greg Johnson

Date: July 18, 2019

Re: Granger Smith Concert

The Cache County Sheriff's Office has reviewed the special event permit application for the "Granger Smith" concert scheduled for August 2, 2019. Public Safety will be handled by the Cache County Sheriff's Office as outlined in the application submitted by the event sponsor and will staff deputies for this event. As far the Sheriff's Office is concerned the permit for this scheduled event can be granted.

Sincerely,

A handwritten signature in black ink, appearing to be "G. Johnson", written over a horizontal line.

Sgt. Greg Johnson

These are approved.

thanks
Jay

***** IMPORTANT MESSAGE *****

This message, including any attachments, may contain confidential information intended for a specific individual and purpose, and is protected by law. If you are not the intended recipient, delete this message, including from trash, and notify me by telephone or email.

If you are not the intended recipient, any distribution or copying of this message, or the taking of any action based on its content is strictly prohibited.

----- Forwarded message -----

From: **Jay Downs** <Jay.Downs@cachecounty.org>

Date: Mon, Jul 22, 2019 at 9:29 AM

Subject: Fwd: SEP for Cherry Peak Concerts

To: <downs.jay@gmail.com>

Good Morning,

Just sending out another email for the upcoming concerts at Cherry Peak. Colbie Caillat is tomorrow night so I will need your response by today. Granger Smith is scheduled for August 2nd. Lifehouse is scheduled for August 23rd.

Thanks

Laurie Jones
Permit Technician
Cache County Development Services
[435.755.1640](tel:435.755.1640)

Laurie Jones - Re: SEP for Cherry Peak Concerts

From: Heidi Johnson <hjohnson@brhd.org>
To: Laurie Jones <Laurie.Jones@cachecounty.org>
Date: 7/22/2019 2:26 PM
Subject: Re: SEP for Cherry Peak Concerts

All of these events are good to go as far as the health department is concerned. Sorry for my late response. I believe all food vendors are accounted for and have the proper permits.

Thanks,
Heidi

On Mon, Jul 22, 2019 at 09:29 Laurie Jones <Laurie.Jones@cachecounty.org> wrote:

Good Morning,
Just sending out another email for the upcoming concerts at Cherry Peak. Colbie Caillat is tomorrow night so I will need your response by today. Granger Smith is scheduled for August 2nd. Lifehouse is scheduled for August 23rd.
Thanks

Laurie Jones
Permit Technician
Cache County Development Services
435.755.1640

--
Heidi Johnson, LEHS
Bear River Health Department
office: 435-695-2061
fax: 435-723-6747
New E-mail: hjohnson@brhd.org



CACHE COUNTY FIRE DISTRICT

179 NORTH MAIN, SUITE 309
LOGAN, UT 84321
TEL: (435) 755-1670
FAX: (435) 755-1994

To: Laurie Jones
From: Jason Winn/Fire Marshal
Date: June 30, 2019
Subject: Granger Smith

Because of the inherently higher life safety risks associated with special events involving gatherings of more than 1000 people the Cache County Fire District will require.

Fire Watch: It is essential for public safety in a place of assembly or any other place where people congregate, because of the number of persons, or the nature of the performance, exhibition, display, contest or activity, the owner, agent or lessee shall provide one or more fire watch personal, as required and approved, to remain on duty during the times such places are open to the public, or when such activity is being conducted. [IFC 403.1]

Public Safety Plan: A public safety plan will need to be submitted to the Cache County Fire District a week prior to the event. Where the fire code official determines that an indoor or outdoor gathering of persons has an adverse impact on public safety through diminished access to buildings, structures, fire hydrants and fire apparatus access roads or where such gatherings adversely affect public safety services of any kind, the fire code official shall have the authority to order the development of, or prescribe a plan for, the provision of any approved level of public safety. [IFC 403.2]

Crowd Managers: Trained crowd managers shall be provided for facilities or events where more than 1,000 persons congregate. The minimum number of crowd managers shall be established at a ratio of one crowd manager to every 250 persons. Where approved by the fire code official, the ratio of crowd managers shall be permitted to be reduced where the facility is equipped throughout with an approved automatic sprinkler system or based upon the nature of the event.

Apparatus Standby: As part of the public safety plan, the event organizer is required to have necessary fire apparatus on-site as determined by the Authority Having Jurisdiction (AHJ). Apparatus standby costs shall be reimbursed to the county at standard deployment rate as determined by Utah Forestry, Fire and State Lands rate agreement.

Parking: A parking manager will need to be assigned to oversee effective parking procedures. Parking will only be allowed on green grass and dirt lots without any vegetation. Parking will only be allowed in the appropriate locations shown on the current conditional use permit. The parking manager must follow all Cache County parking restrictions.

Fireworks: Fireworks are not allowed per Authority Having Jurisdiction

From: Jared Roos <jared.roos@cachecounty.org>
To: Laurie.Jones@cachecounty.org
Date: 7/22/2019 10:30 AM
Subject: Special Event Granger Smith Cherry peak August 2nd

After talking to Joel Merritt at road department they won't have anything that will effect this event.

Sent from my iPad

Laurie Jones - Re: SEP for Cherry Peak Concerts

From: Paul Berntson
To: Laurie Jones
Date: 7/30/2019 8:20 PM
Subject: Re: SEP for Cherry Peak Concerts

Laurie
go for it
PB

>>> Laurie Jones 7/22/2019 9:27 AM >>>

Good Morning,

Just sending out another email for the upcoming concerts at Cherry Peak. Colbie Caillat is tomorrow night so I will need your response by today. Granger Smith is scheduled for August 2nd. Lifehouse is scheduled for August 23rd.

Thanks

Laurie Jones
Permit Technician
Cache County Development Services
435.755.1640



Cache County

1857

DEVELOPMENT SERVICES DEPARTMENT

BUILDING | SURVEYING | ENGINEERING | GIS | PLANNING & ZONING | ROADS | WEEDS

APPLICATION: SPECIAL EVENT PERMIT

2019-20

Date Received:	By:	Receipt #:	Check #:	Amount:
7/16/19	J Jones	12724	800	\$75.00

EVENT INFORMATION

Event: Granger Smith Type: Concert

Dates with starting/ending times: Aug 2ND 5:00 - 10:00 P.M.

AGENT/CONTACT INFORMATION

Agent/Contact: John Chadwick Email: john@skicherrypeak.us

Phone: 435-890-1827 Mailing Address: P.O. Box 534 Logan, UT, 84333

Name of Promoting Entity: Cherry Peak Resort U.S.

ACKNOWLEDGMENT

In accordance with Title 8 Section 8.40 of the Cache County Ordinance, I hereby submit and certify that the information contained in this application is accurate and complete to the best of my knowledge.

[Signature]
Applicant _____ Date _____

Application Deadline: Completed application forms must be submitted to the Cache County Development Services Office forty-five (45) calendar days before an event is scheduled to take place. This allows sufficient time for evaluation of the application. Late applications shall be denied unless the applicant demonstrates that compliance with the 45 day deadline was impractical or impossible due to the nature of the event. A special event permit application may be approved and a permit issued to the applicant by the Director upon approval by all the agencies specified in Section 8.40.40.

Authority: Cache County has no authority to approve permits for events other than in the unincorporated area of Cache County. Permits issued by Cache County apply only to the unincorporated area of the county, and if an event crosses into a municipality within Cache County or across the county line, applicants should determine if a permit is necessary in the other jurisdiction.

Right to Deny: Cache County reserves the right to deny permit applications for proposed special events which may pose, or have posed a significant danger or threat to the public health, welfare or safety, or which may result in unreasonable inconvenience or cost to the public. In the event the application is denied, the applicant may appeal to the Cache County Executive.

#3. Total number of Participants estimated

July 23 rd	Colby Calais	2,500 - 3,500
Aug. 2 nd	Granger Smith	2,700 - 3,700
Aug 23 rd	Life House	2,500 - 3,500

#4 The Resort has 17 toilets
and 6 urinals in the Lodge
This fits within the requirements
for events of this size & duration.

received
12 July 19

Law Enforcement Security Plan for Cherry Peak Resort C.U.P.

For Concerts and Events from 1,000 to 2,000 customers 2 officers Required

2,001 to 3,000	3 officers
3,001 to 6,000	4 officers
6,000 to 10,000	6 officers
10,000 plus customers	10 officers

(numbers are based on best estimates per event)

Estimated numbers will be provided to the Sheriff's office two weeks in advance of each event.

1 security personnel provided by Cherry Peak Staff for ever 250 Participants. All security, parking attendants and deputies will access to radios for communication.

Understood that the minimum number of hours per deputy is two hours.

Communication to the buses is through the radios to parking attendants or directly as needed.

All parking attendants and security are trained about proper ingress and egress and will direct customers accordingly.

Busses will not park in fire lane at the lodge for loading or unloaded if not attended.

It is understood that the Fire Department has an agreement for parking, fire protection, ingress and egress.

In the event of rain making it difficult to park in the designated field for the events arrangements have been made and a plan for alternate parking with Richmond City.

See Attached

Public Safety Plan

7-12-19



Cache County Sheriff's Office
Lt. Barfschi

FD-4

Cherry Peak Resort LLC

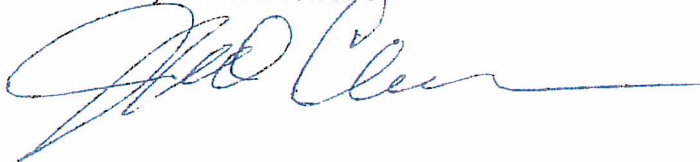

7-12-19

Cherry Peak Resort Fire Protection and Public Safety Plan for C.U.P.

received
12 July 19

For Events and activities over 1,000 customers a minimum of 1 security for every 250 participants.

Fire Extinguishers will be placed around the perimeter of the event as follows:

- 1 by the pump house water hydrants east of lawn
- 1 by the stage
- 1 by the magic carpet hydrant north east of the lodge 200 feet
- 1 at each temporary parking location
- 1 extinguishers in the lodge will be left alone and not moved

All parking attendants will be trained about egress and ingress and guide parking accordingly.

Buses will not be unattended if parking in the fire lane.

All fire and emergency lanes will be left open for adequate access for emergency vehicles.

Fire Department will be notified two weeks in advance of each event over 1000 people to discuss any alterations or adjustments to the plan that different events may require.

Temporary event parking will be in the fields to the west where it has occurred in the past.
See Attached

Richmond City has agreed for emergency parking in the event of inclement weather.

The Fire Hydrant is 85 feet south of the lodge along the driveway.

During events fire hoses will be attached to the snowmaking hydrants as follows.

- 1 by the pump house
- 1 at the top of the conveyor lift.
- 1 midway up the conveyor lift

One employee will be assigned to be fire watch for each event where fire is a possibility. A fire watch may or may not be required and will be determined by the Fire Marshal as needed.

See attached parking location and pattern plans:

- Attachment A- Onsite Parking
- Attachment B- Non Rain/ Field Parking
- Attachment C- Rain Event / Overflow Parking

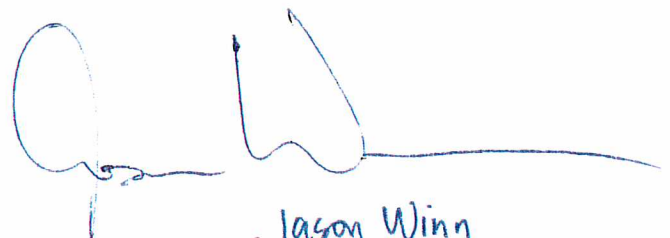

Jason Winn
Cache County Fire
12 July 19

11/15/2001 WISB/LL



SCALE: 1" = 150'

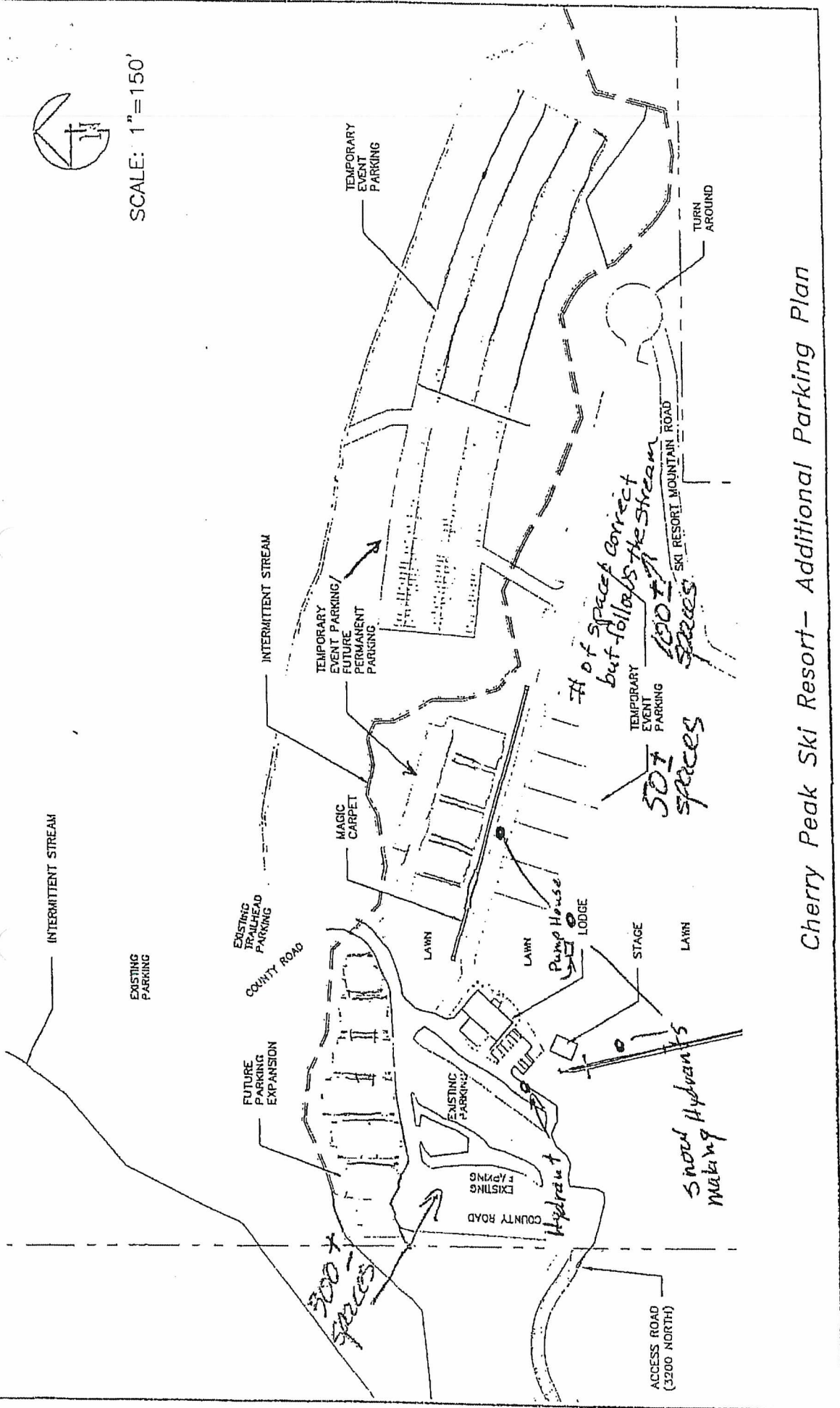

Cherry Peak Ski Resort - Additional Parking Plan

Attachment B

CHERRY CREEK ROAD

OFF-SITE FLOWING PLAN
FOR 21425
1"=100' HOR

EXISTING COUNTY R-0-2
EXISTING ROADWAY

- NOTES:
1. Minimum road width: 25'
 2. Minimum parking stall size: 8'x20'
 3. Ends of each parking stall to be marked with orange flagging.
 4. Total parking stalls: 1264
West stalls: 903
East stalls: 361

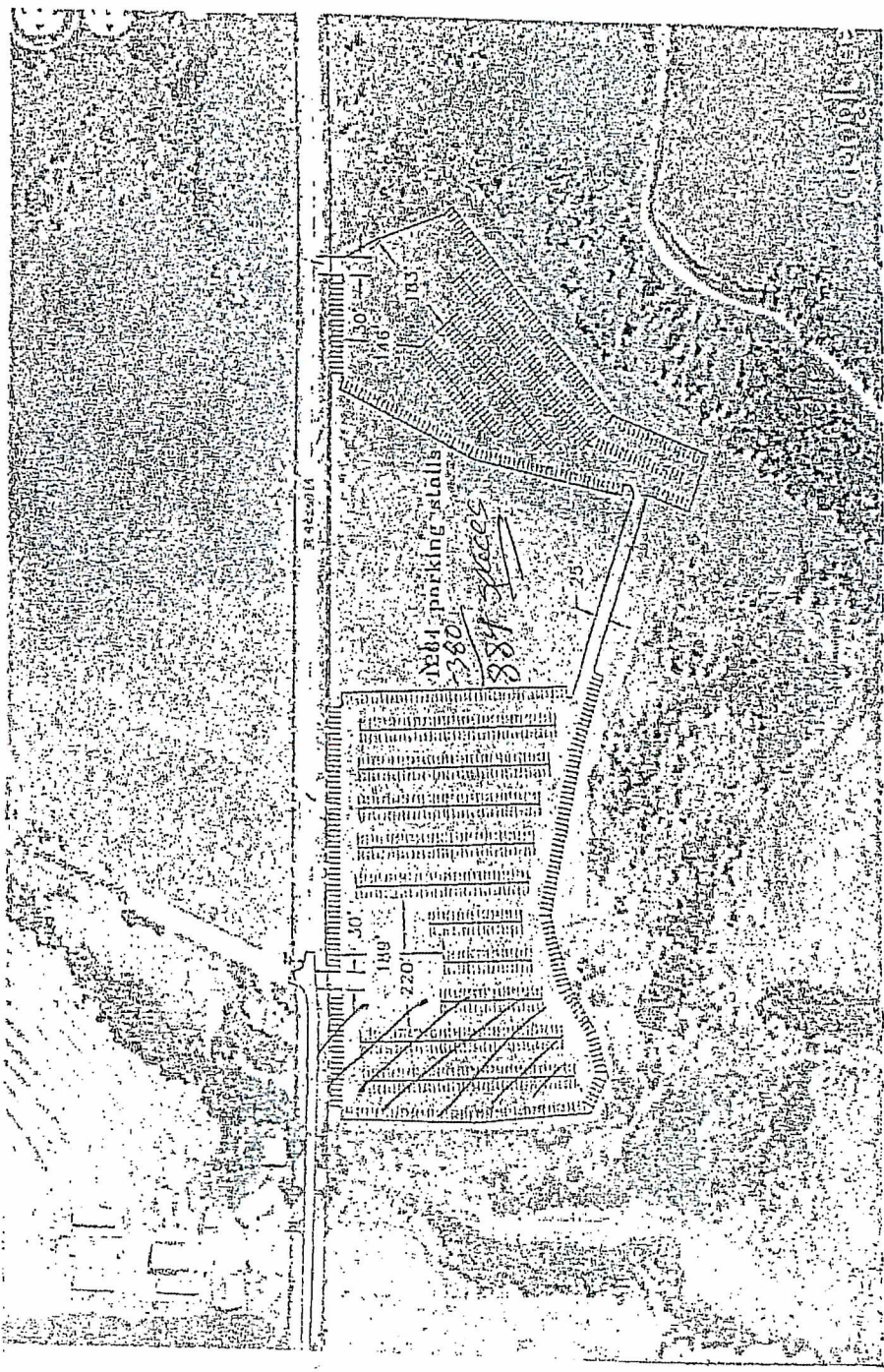

CHERRY CREEK ROAD
OFF-SITE FLOWING PLAN



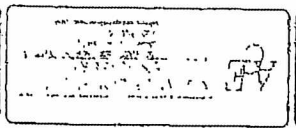





NO.	DATE/REVISION	BY	CHKD



Alternate Parking Plan

620 Total Stalls

Legend

-  BEAR RIVER MIGRATORY BIRD REFUGE
-  Cache County Sheriff Office
-  Cache Valley Counter Tops Inc
-  Feature 1
-  Feature 2
-  Maverik Country Store
-  Path Measure
-  Richmond City Library

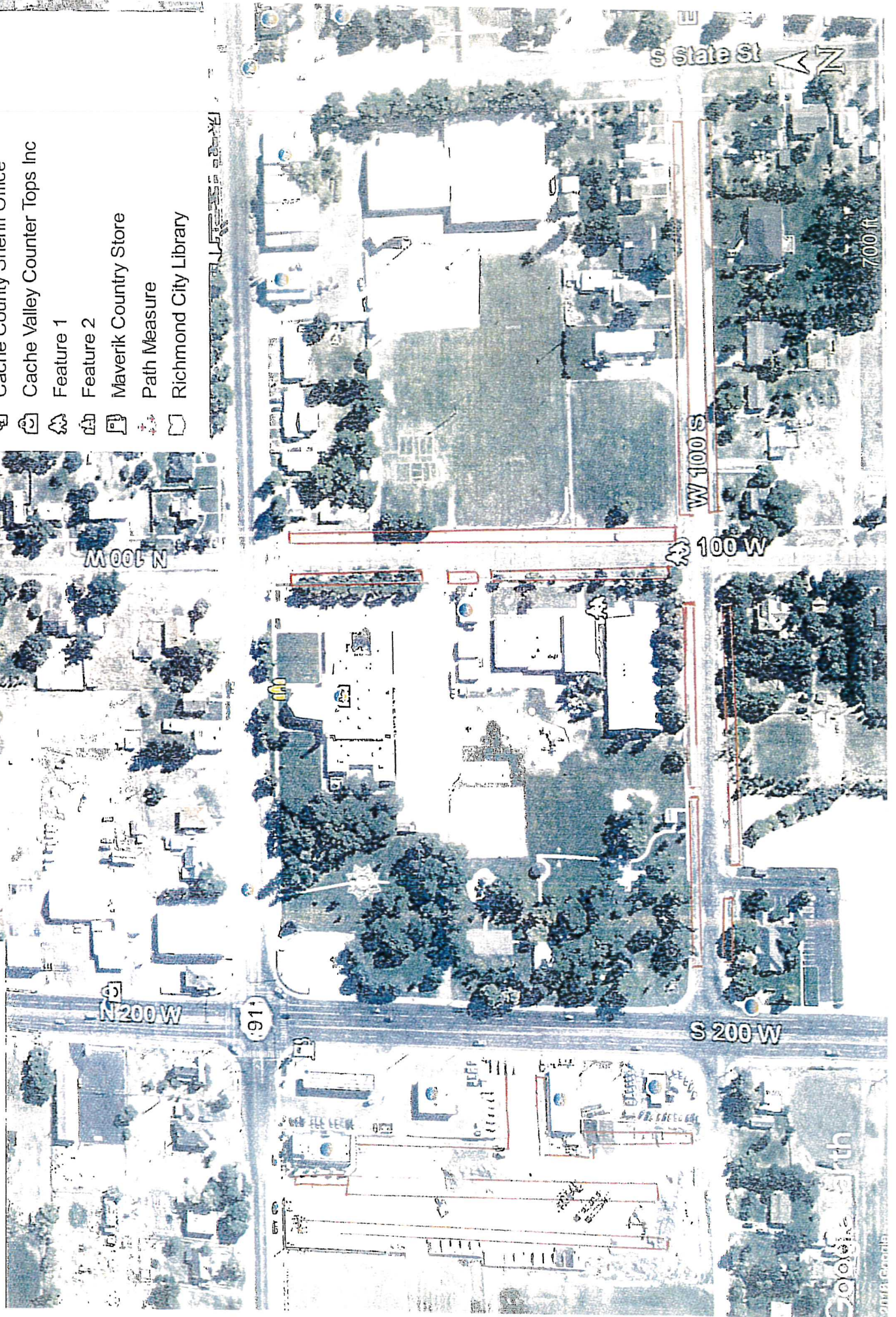



CERTIFICATE OF LIABILITY INSURANCE

DATE (MM/DD/YYYY)
3/12/2019

THIS CERTIFICATE IS ISSUED AS A MATTER OF INFORMATION ONLY AND CONFERS NO RIGHTS UPON THE CERTIFICATE HOLDER. THIS CERTIFICATE DOES NOT AFFIRMATIVELY OR NEGATIVELY AMEND, EXTEND OR ALTER THE COVERAGE AFFORDED BY THE POLICIES BELOW. THIS CERTIFICATE OF INSURANCE DOES NOT CONSTITUTE A CONTRACT BETWEEN THE ISSUING INSURER(S), AUTHORIZED REPRESENTATIVE OR PRODUCER, AND THE CERTIFICATE HOLDER.

IMPORTANT: If the certificate holder is an ADDITIONAL INSURED, the policy(ies) must have ADDITIONAL INSURED provisions or be endorsed. If SUBROGATION IS WAIVED, subject to the terms and conditions of the policy, certain policies may require an endorsement. A statement on this certificate does not confer rights to the certificate holder in lieu of such endorsement(s).

PRODUCER Commercial Lines - 877-281-5690 (CA DOI # 0G13561) Safehold Special Risk, Inc. 601 Union Street, 10th Floor Seattle, WA 98101	CONTACT NAME: PHONE (A/C, No, Ext): FAX (A/C, No): E-MAIL ADDRESS: <table style="width: 100%; border: none;"> <tr> <td style="text-align: center; border: none;">INSURER(S) AFFORDING COVERAGE</td> <td style="text-align: center; border: none;">NAIC #</td> </tr> <tr> <td style="border: none;">INSURER A : NOVA Casualty Company</td> <td style="border: none;">42552</td> </tr> <tr> <td style="border: none;">INSURER B :</td> <td style="border: none;"></td> </tr> <tr> <td style="border: none;">INSURER C :</td> <td style="border: none;"></td> </tr> <tr> <td style="border: none;">INSURER D :</td> <td style="border: none;"></td> </tr> <tr> <td style="border: none;">INSURER E :</td> <td style="border: none;"></td> </tr> <tr> <td style="border: none;">INSURER F :</td> <td style="border: none;"></td> </tr> </table>	INSURER(S) AFFORDING COVERAGE	NAIC #	INSURER A : NOVA Casualty Company	42552	INSURER B :		INSURER C :		INSURER D :		INSURER E :		INSURER F :	
INSURER(S) AFFORDING COVERAGE	NAIC #														
INSURER A : NOVA Casualty Company	42552														
INSURER B :															
INSURER C :															
INSURER D :															
INSURER E :															
INSURER F :															
INSURED Cherry Peak Resort, LLC 3200 E 11000 N Richmond, UT 84333															

COVERAGES
CERTIFICATE NUMBER: 14000631

REVISION NUMBER: See below

THIS IS TO CERTIFY THAT THE POLICIES OF INSURANCE LISTED BELOW HAVE BEEN ISSUED TO THE INSURED NAMED ABOVE FOR THE POLICY PERIOD INDICATED. NOTWITHSTANDING ANY REQUIREMENT, TERM OR CONDITION OF ANY CONTRACT OR OTHER DOCUMENT WITH RESPECT TO WHICH THIS CERTIFICATE MAY BE ISSUED OR MAY PERTAIN, THE INSURANCE AFFORDED BY THE POLICIES DESCRIBED HEREIN IS SUBJECT TO ALL THE TERMS, EXCLUSIONS AND CONDITIONS OF SUCH POLICIES. LIMITS SHOWN MAY HAVE BEEN REDUCED BY PAID CLAIMS.

INSR	TYPE OF INSURANCE	ADDL INSD	SUBR WVD	POLICY NUMBER	POLICY EFF (MM/DD/YYYY)	POLICY EXP (MM/DD/YYYY)	LIMITS
X	COMMERCIAL GENERAL LIABILITY <input type="checkbox"/> CLAIMS-MADE <input checked="" type="checkbox"/> OCCUR X SIR: 10,000 Occ. X SIR: 50,000 Agg. GEN'L AGGREGATE LIMIT APPLIES PER: <input type="checkbox"/> POLICY <input type="checkbox"/> PRO-JECT <input type="checkbox"/> LOC OTHER:			WFR-GL-10000142-01	03/12/2019	03/12/2020	EACH OCCURRENCE \$ 1,000,000 DAMAGE TO RENTED PREMISES (Ea occurrence) \$ 1,000,000 MED EXP (Any one person) \$ EXCLUDED PERSONAL & ADV INJURY \$ 1,000,000 GENERAL AGGREGATE \$ NONE PRODUCTS - COMP/OP AGG \$ 2,000,000 \$
	AUTOMOBILE LIABILITY <input type="checkbox"/> ANY AUTO <input type="checkbox"/> OWNED AUTOS ONLY <input type="checkbox"/> HIRED AUTOS ONLY <input type="checkbox"/> SCHEDULED AUTOS <input type="checkbox"/> NON-OWNED AUTOS ONLY						COMBINED SINGLE LIMIT (Ea accident) \$ BODILY INJURY (Per person) \$ BODILY INJURY (Per accident) \$ PROPERTY DAMAGE (Per accident) \$ \$
	UMBRELLA LIAB <input type="checkbox"/> OCCUR EXCESS LIAB <input type="checkbox"/> CLAIMS-MADE DED <input type="checkbox"/> RETENTION \$						EACH OCCURRENCE \$ AGGREGATE \$ \$
	WORKERS COMPENSATION AND EMPLOYERS' LIABILITY ANY PROPRIETOR/PARTNER/EXECUTIVE OFFICER/MEMBER EXCLUDED? (Mandatory in NH) If yes, describe under DESCRIPTION OF OPERATIONS below	Y/N	N/A				PER STATUTE <input type="checkbox"/> OTH-ER <input type="checkbox"/> E.I. EACH ACCIDENT \$ E.I. DISEASE - EA EMPLOYEE \$ E.I. DISEASE - POLICY LIMIT \$

DESCRIPTION OF OPERATIONS / LOCATIONS / VEHICLES (ACORD 101, Additional Remarks Schedule, may be attached if more space is required)

Evidence Only

CERTIFICATE HOLDER

 Cache County Corporation
 179 North Main
 Logan, UT 84321

CANCELLATION

SHOULD ANY OF THE ABOVE DESCRIBED POLICIES BE CANCELLED BEFORE THE EXPIRATION DATE THEREOF, NOTICE WILL BE DELIVERED IN ACCORDANCE WITH THE POLICY PROVISIONS.

AUTHORIZED REPRESENTATIVE

The ACORD name and logo are registered marks of ACORD © 1988-2015 ACORD CORPORATION. All rights reserved.

NOVA Casualty Company

A.M. Best #: 002708 NAIC #: 42552 FEIN #: 161140177

Administrative Office

440 Lincoln Street
Worcester, MA 01653-0002
United States

[View Additional Address Information](#)

Financial Strength Rating

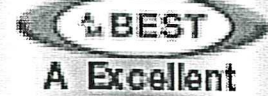

Assigned to insurance companies that have, in our opinion, an excellent ability to meet their ongoing insurance obligations.

Web: www.hanover.com

Phone: 508-853-7200

Fax: 508-853-6332

[View additional news, reports and products for this company.](#)

Based on A.M. Best's analysis, 058505 - The Hanover Insurance Group, Inc. is the **AMB Ultimate Parent** and identifies the topmost entity of the corporate structure. [View a list of operating insurance entities in this structure.](#)

Best's Credit Ratings

Financial Strength Rating [View Definition](#)

Rating: A (Excellent)
Affiliation Code: r (Reinsured)
Financial Size Category: XV (\$2 Billion or greater)
Outlook: Stable
Action: Affirmed
Effective Date: June 07, 2018
Initial Rating Date: June 30, 1989

Long-Term Issuer Credit Rating [View Definition](#)

Long-Term: a
Outlook: Stable

Action: Affirmed
Effective Date: June 07, 2018
Initial Rating Date: May 02, 2007

u Denotes Under Review Best's Rating

Best's Credit Rating Analyst

Rating Office: A.M. Best Rating Services, Inc.

Senior Financial Analyst: Michael T. Venezia

Director: Jacqualene Lentz, CPA

Note: See the Disclosure information Form or Press Release below for the office and analyst at the time of the rating event.

Disclosure Information

Disclosure Information Form

View A.M. Best's Rating Disclosure Form

Press Release

A.M. Best Affirms Credit Ratings of The Hanover Insurance Group, Inc. and Its Subsidiaries
June 07, 2018

Rating History

A.M. Best has provided ratings & analysis on this company since 1989.

Financial Strength Rating

Effective Date Rating

6/7/2018	A
5/25/2017	A
5/19/2016	A
5/22/2015	A
5/16/2014	A

Long-Term Issuer Credit Rating



Cache County Corporation
2019 - Tax Roll Information
 18-057-0021

Owner's Name & Address

Parcel **18-057-0021** Entry **1096438**
 Name **CHERRY PEAK RECREATIONAL RESER**
 C/O Name
 Address **PO BOX 534**

 City, ST Zip **LOGAN, UT 84323-0534**
 District **017 RICHMOND CEMETERY**
 Year **2019** Status **TX**

Owner(s) List

1 CHERRY PEAK RECREATIONAL RESERVE LLC,
1096438 1787/1459

Property Address

Address **3320 E 11000 N**
 City **RICHMOND**
 Assr Review **1/24/2018**

PARCEL HISTORY

PT 18-057-0003,0016,0017 & PT 18-054-0003,0005,0006 10/17;

LEGAL DESCRIPTION FOR 2019

LOT 1 RICHMOND VALLEY SUBDIVISION CONT 139.32 AC
 SIT SECS 20 & 29 T 14N R 2E

PROPERTY INFORMATION

		2018			2019		
		Acres	Market	Taxable	Acres	Market	Taxable
BC	BUILDING COMMERCIAL		1,750,300	1,750,300		1,750,300	1,750,300
LC	LAND COMMERCIAL		698,656	698,655	139.32	698,656	698,655
TOTALS		139.32	2,448,956	2,448,955	139.32	2,448,956	2,448,955

BUILDING & TAX INFORMATION

Square Footage: **10,000**
 Year Built: **2014**
 Building Type: **Comm**

2018 (Certified Tax Rate: 0.010302)

Taxes:	25,229.13
Special:+	0.00
Rollback:+	0.00
Pen/Int:+	1,541.23
Abatements:-	0.00
Payments:-	26,770.36
Balance Due:	0.00

2018 Last Payment Date: 6/12/2019

BACK TAX SUMMARY

NO BACK TAXES



Cache County Corporation
2019 - Tax Roll Information
 18-057-0023

Owner's Name & Address

Owner(s) List

Parcel **18-057-0023** Entry **1183781**
 Name **HALL, MARK**
 C/O Name
 Address **3000 S SIERRA VISTA WAY**

 City, ST Zip **PROVO, UT 84606-6238**
 District **017 RICHMOND CEMETERY**
 Year **2019** Status **TX**

1 HALL, MARK
1183781 1978/1643

Property Address

Address
 City **COVE**
 Assr Review **1/25/2018**

PARCEL HISTORY

PT 18-057-0003,0016,0017 & PT 18-054-0003,0005,0006 10/17;

LEGAL DESCRIPTION FOR 2019

LOT 3 RICHMOND VALLEY SUBDIVISION CONT 20.04 AC
 SIT SECS 20 & 29 T 14N R 2E

PROPERTY INFORMATION

	2018			2019		
	Acres	Market	Taxable	Acres	Market	Taxable
LV LAND VACANT		362,600	362,600	20.04	362,600	362,600
TOTALS	20.04	362,600	362,600	20.04	362,600	362,600

BUILDING & TAX INFORMATION

2018 (Certified Tax Rate: 0.010302)

Taxes:	3,735.51
Special: +	0.00
Rollback: +	0.00
Penalty: +	37.36
Abatements: -	0.00
Payments: -	3,772.87
Balance Due:	0.00

2018 Last Payment Date: 12/31/2018

BACK TAX SUMMARY

NO BACK TAXES



Cache County Corporation
2019 - Tax Roll Information

09-045-0002

Owner's Name & Address

Parcel **09-045-0002** Entry **1207675**
Name **CHRISTENSEN, BRET & CHARLA**
C/O Name
Address **1574 E 13000 N**

City, ST Zip **COVE, UT 84320-2105**
District **017 RICHMOND CEMETERY**
Year **2019** Status **TX**

Owner(s) List

1 CHRISTENSEN, BRET & CHARLA
1207675 2046/1503

Property Address

Address
City
Assr Review **4/12/2019**

PARCEL HISTORY

PT THIS, REM TO 0018 & 0033 11/18;

LEGAL DESCRIPTION FOR 2019

eginning at the Northwest corner of Section 25 T 14N R 1E, from which the Northeast corner of Section 25 bears North 89° 36' 53" East 5300.32 feet;
Thence North 89° 36' 53" East 1511.35 feet along the North line of said Section 25, also being the centerline of 11000 North Street, to the True Point of Beginning;
Thence continuing North 89° 36' 53" East 2020.07 feet to the intersection of said 11000 North Street and a private un named gravel road;
Thence along the centerline of said un named gravel road the following 8 courses:
Thence South 16° 00' 29" East 71.12 feet;
Thence South 11° 16' 56" East 156.94 feet;
Thence South 09° 58' 51" East 188.62 feet;
Thence South 17° 34' 30" East 94.53 feet;
Thence South 18° 21' 29" East 94.88 feet;
Thence South 11° 35' 44" East 64.34 feet;
Thence South 09° 23' 31" East 63.66 feet;
Thence South 03° 13' 08" East 31.09 feet to the intersection of said un named gravel road and the Cherry Creek Canal road;
Thence along said Cherry Creek Canal road the following 16 courses:
Thence North 79° 18' 50" West 44.19 feet;
Thence North 72° 15' 52" West 95.79 feet;
Thence North 68° 35' 37" West 233.51 feet to the beginning of a 125.00 feet radius centerline curve concave to the Southwest;
Thence Northwesterly along said centerline curve through a central angle of 15° 22' 03" a distance of 33.53 feet (chord = North 76° 16' 39" West 33.43 feet);
Thence North 83° 57' 40" West 108.57 feet;
Thence North 88° 16' 23" West 186.93 feet;
Thence North 84° 04' 16" West 65.19 feet;
Thence North 80° 52' 10" West 123.46 feet to the beginning of a 125.00 feet radius centerline curve concave to the Southeast;
Thence Southwesterly along said centerline curve through a central angle of 71° 24' 13" a distance of 155.78 feet (chord = South 63° 25' 44" West 145.89 feet);
Thence South 27° 43' 37" West 67.06 feet;
Thence South 16° 56' 25" West 93.95 feet;
Thence South 35° 51' 39" West 62.60 feet;
Thence South 40° 52' 25" West 159.66 feet;



Cache County Corporation
 2019 - Tax Roll Information
 09-045-0002

LEGAL DESCRIPTION FOR 2019 (Continued)

Thence South 37° 11' 34" West 61.31 feet;
 Thence South 33° 11' 40" West 62.55 feet;
 Thence South 57° 01' 30" West 43.89 feet;
 Thence North 71° 20' 00" West 307.14 feet along a fence line and its extension to a 5/8" rebar with cap labeled, "A.A. Hudson, PLS 375041" set at a fence angle point;
 Thence North 58° 09' 06" West 310.31 feet along said fence line to a 5/8" rebar with cap set at a fence angle point;
 Thence South 72° 21' 11" West 207.57 feet along said fence to a 5/8" rebar with cap;
 Thence North 06° 44' 25" East 365.72 feet to a 5/8" rebar with cap;
 Thence North 18° 49' 45" West 534.93 feet to the True Point of Beginning.
 Containing 35.6 acres of land.
 Subject to the publics right of way on 11000 North Street.

PROPERTY INFORMATION

	Acres	2018		Acres	2019	
		Market	Taxable		Market	Taxable
LG LAND GREENBELT		356,500	10,255	35.60	195,480	4,320
TOTALS	97.00	356,500	10,255	35.60	195,480	4,320

GREENBELT INFORMATION

Class	Description	Acres	Market	Taxable
IT	IRRIGATION TILLABLE IV	13.35	73,305	40
GZ	GRAZING II	22.25	122,175	425
DT	DRY TILLABLE IV	0.00	0	0
Totals		35.60	195,480	500

BUILDING & TAX INFORMATION

2018 (Certified Tax Rate: 0.010302)

Taxes:	105.65
Special:+	0.00
Rollback:+	0.00
Penalty:+	0.00
Abatements:-	0.00
Payments:-	105.65
Balance Due:	0.00

2018 Last Payment Date: 10/19/2018

BACK TAX SUMMARY

NO BACK TAXES